

DOCUMENT 2.3A

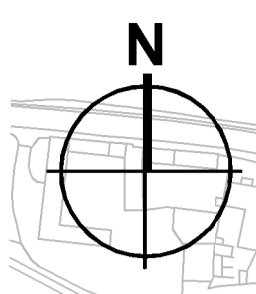

- KEY**
- ORDER LIMITS
 - NEW ALL PURPOSE HIGHWAY CREATED
 - NEW PRIVATE ROAD
 - EXISTING ALL PURPOSE HIGHWAY TO BE STOPPED UP
 - EXISTING ALL PURPOSE HIGHWAY TO BE STOPPED UP AND BECOME PRIVATE ROAD
 - EXISTING ADOPTED HIGHWAY (TO REMAIN AS ADOPTED HIGHWAY) TO WHICH NEW ACCESS ARE CREATED
 - EXISTING PRIVATE ROAD (TO REMAIN AS PRIVATE ROAD)
 - EXISTING PRIVATE ROAD TO BE CLOSED
 - EXISTING PRIVATE ROAD TO BE CLOSED AND BECOME PUBLIC CYCLE/FOOTPATH
 - NEW CYCLE TRACK/FOOTPATH
 - NEW PERMISSIVE ROUTE FOR PEDESTRIANS AND CYCLISTS
 - IMPROVEMENT TO EXISTING CYCLEWAY / FOOTWAY TRACK
 - NEW CYCLEWAY / FOOTWAY
 - NEW PUBLIC FOOTWAY
 - RELOCATED PUBLIC FOOTWAY
 - IMPROVEMENT TO EXISTING PUBLIC FOOTWAY
 - NEW PRIVATE FOOTPATH
 - EXISTING PUBLIC RIGHT OF WAY TO BE STOPPED UP
 - PEDESTRIAN / CYCLE CROSSING POINT (SUBJECT TO FINAL POSITIONING OF PERMISSIVE PATHS)
 - INDICATIVE DEVELOPMENT PLOT ENTRANCE
 - BLOCKED ACCESS THROUGH CENTRAL RESERVATION (NEW PERMANENT TRAFFIC REGULATION ORDER)
 - ACCESS CLOSED
 - 4 REFERENCE LABEL

NOTE: LIMITS OF DEVIATION SHOWN ON THE WORKS PLANS (DOCUMENT SERIES 2.2) AND SET OUT IN ARTICLE 4 OF THE DEVELOPMENT CONSENT ORDER

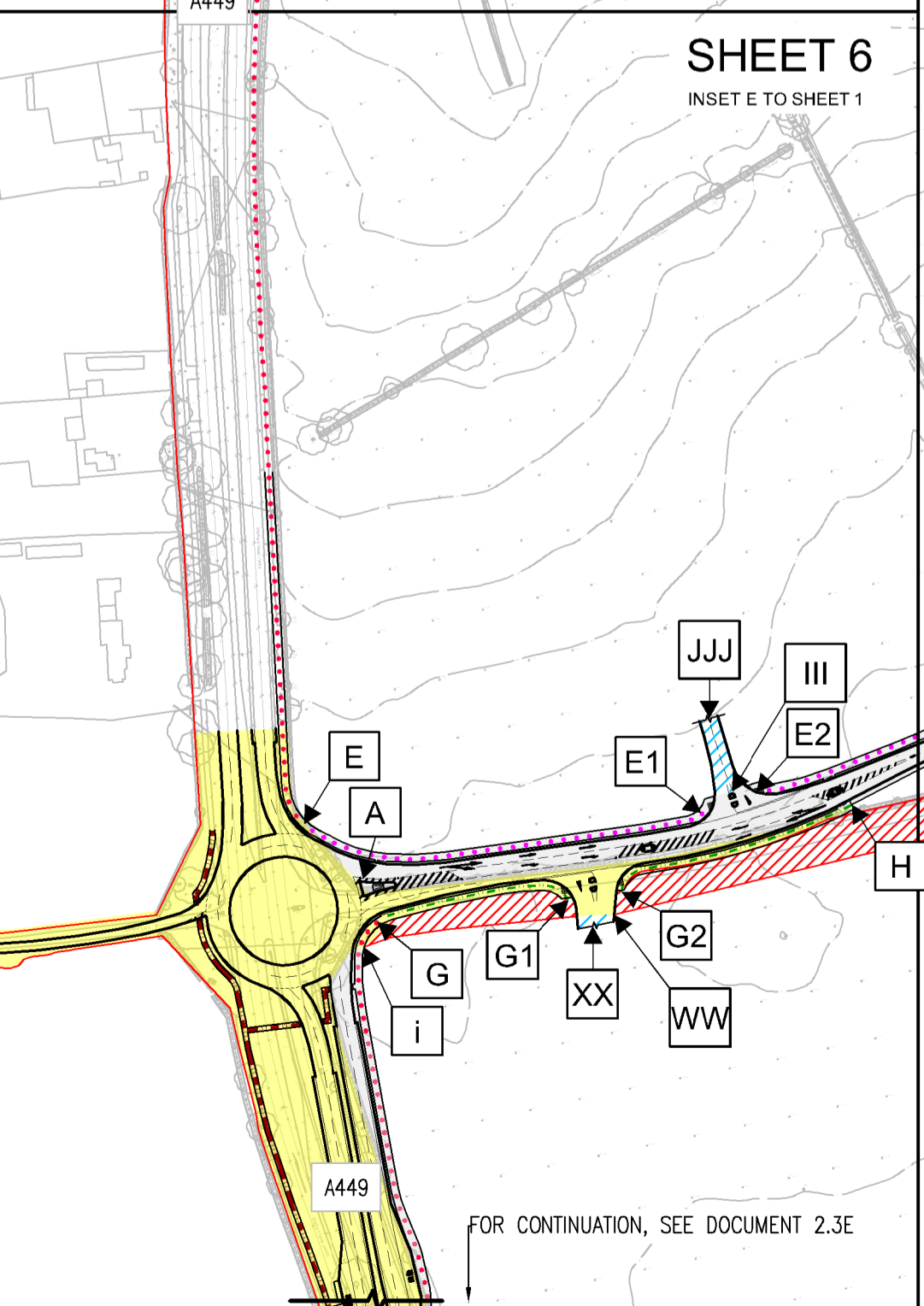
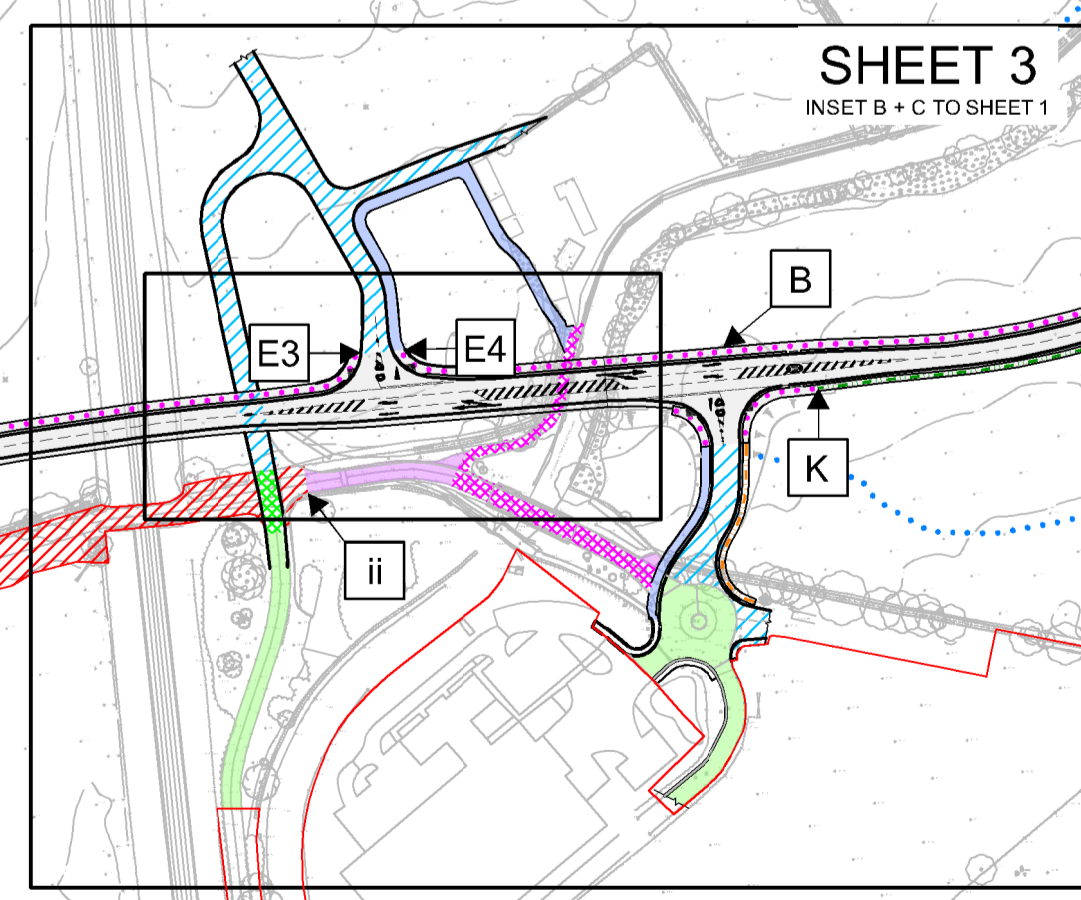
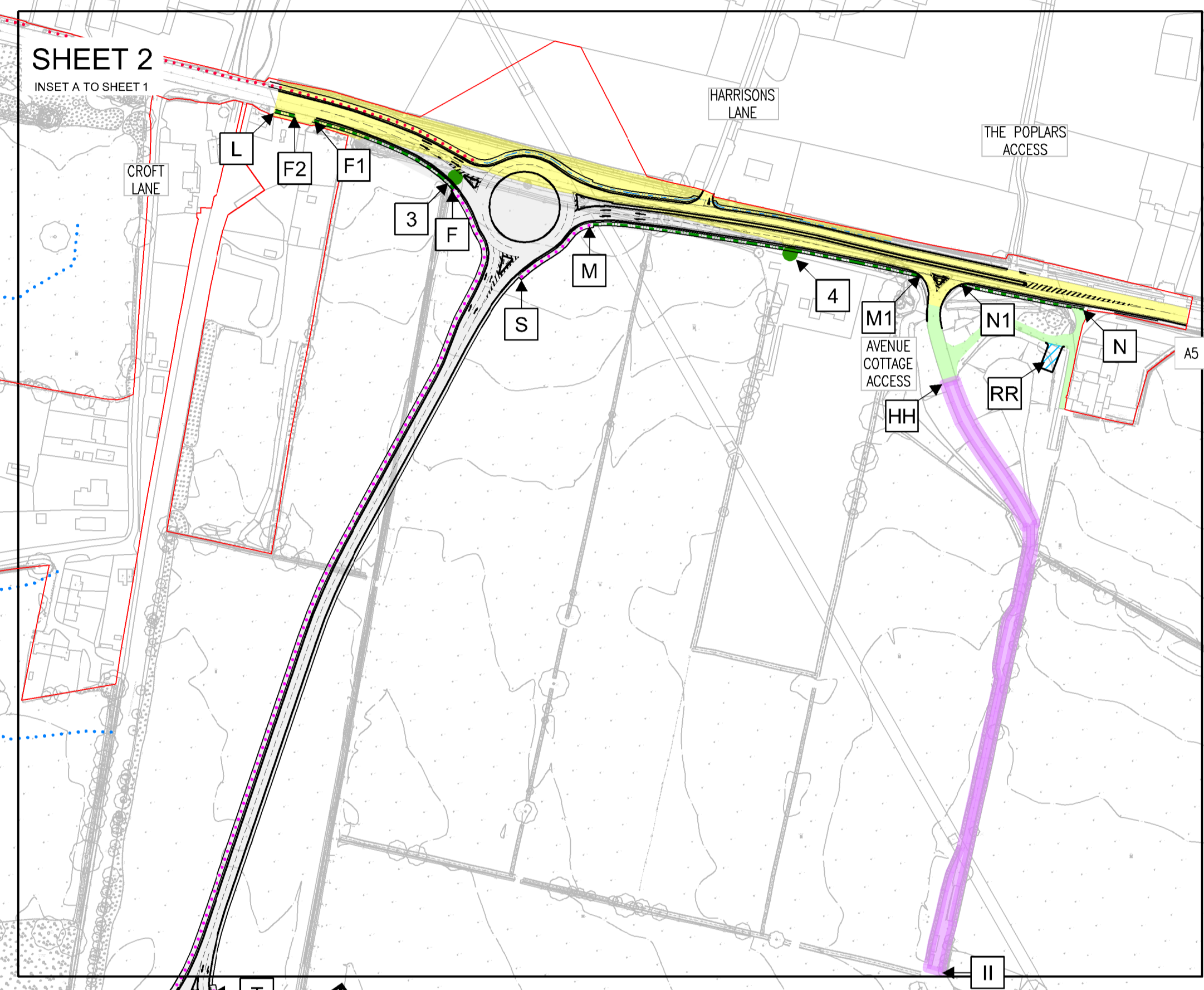
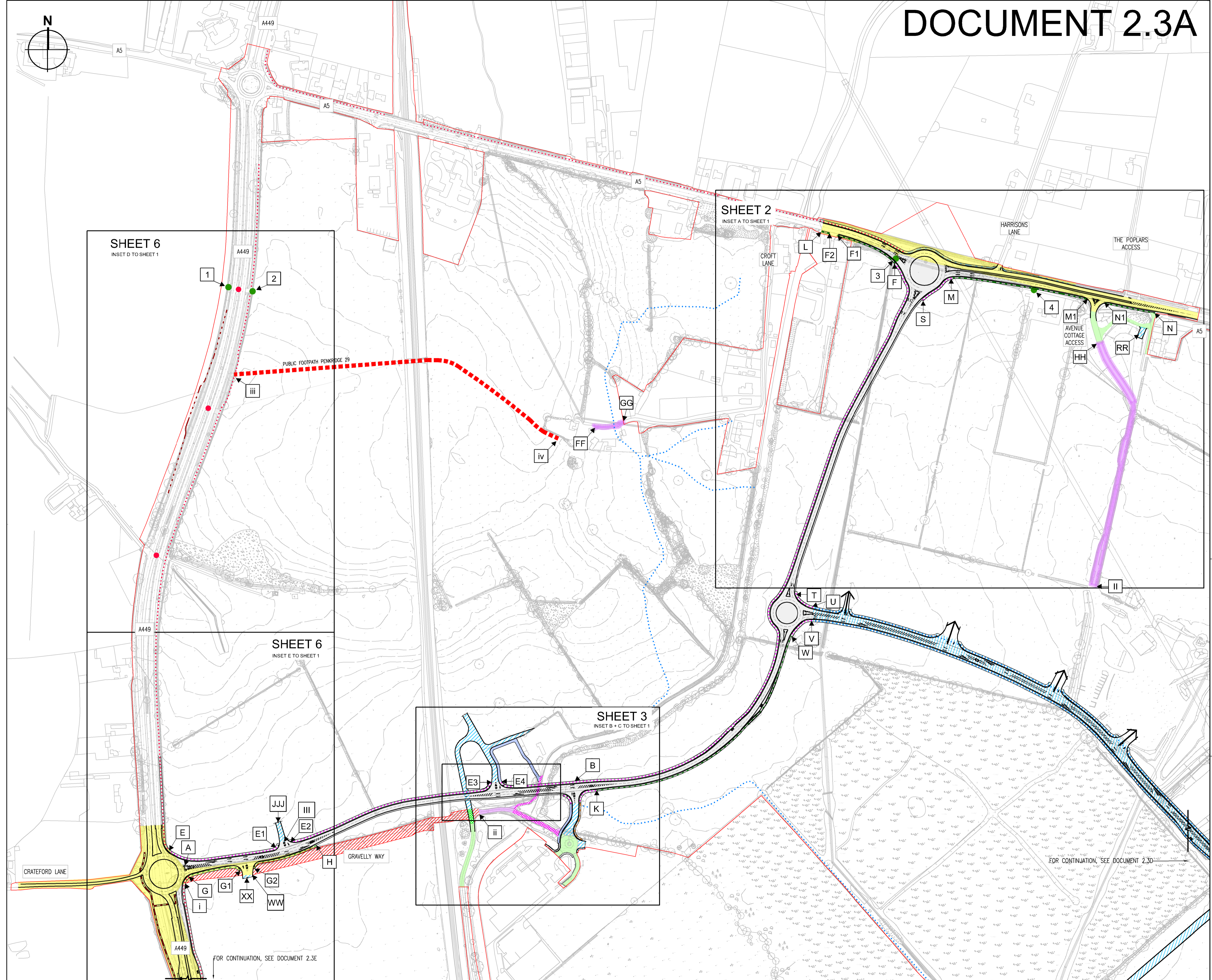
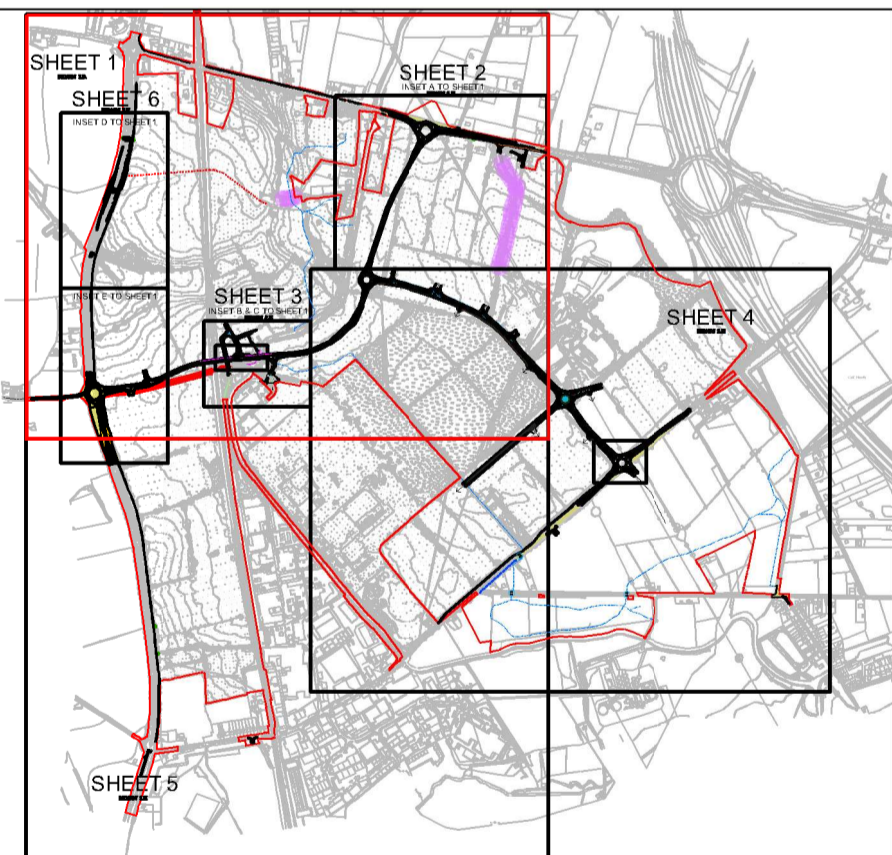

E - MINOR AMENDMENTS	
D - MINOR AMENDMENTS	
C - HIGHWAY LAYOUT UPDATED	
B - HIGHWAY LAYOUT UPDATED	
Revisions: A - FIRST ISSUE	
Project THE WEST MIDLANDS RAIL FREIGHT INTERCHANGE ORDER 201X	
Drawing Status SUBMISSION	
Drawing Title	Drawing Size A1
ACCESS AND RIGHTS OF WAY PLAN SHEET 1	
Regulation 5 (2) (K)	Document 2.3A
Drawn NW	Date: JUNE 2018 Scale: 1:2500
Reviewed IF	Rev: E
Drawing No. WSP-70001979-SK-060	